

# ET-0804C-M12

## 12 Port M12 Industrial Unmanaged PoE+ Booster Gigabit Ethernet Switch



- Compliant with EN50155
- 8x 10/100T(x) M12 connector with IEEE 802.3at PoE+
- 4x 10/100/1000T(x) M12 connector, with 2x relay bypass
- Support Bypass function for non-stop communication even when no power exists
- Built for harsh environments and wide temperature range application
- IP40/IP54(Optional) housing
- Isolated redundant PoE power 165W



### Specifications

#### Technology

|                  |  |
|------------------|--|
| <b>Standards</b> | IEEE 802.3 10BaseT<br>IEEE 802.3u 100BaseTX<br>IEEE 802.3ab 1000BaseT<br>IEEE 802.3af Power over Ethernet<br>IEEE 802.3at PoE+ |
|------------------|--|

|                        |                   |
|------------------------|-------------------|
| <b>Processing Type</b> | Store and Forward |
|------------------------|-------------------|

#### Switch Properties

|                      |         |
|----------------------|---------|
| <b>Switch Fabric</b> | 9.6Gbps |
|----------------------|---------|

|                        |   |
|------------------------|---|
| <b>Priority Queues</b> | - |
|------------------------|---|

|                       |    |
|-----------------------|----|
| <b>MAC Table Size</b> | 8K |
|-----------------------|----|

|                      |        |
|----------------------|--------|
| <b>Packet Buffer</b> | 4Mbits |
|----------------------|--------|

#### Interface

|                          |   |
|--------------------------|---|
| <b>Network Connector</b> | 8x 10/100T(x) M12 Female D-coded 4-pole with PoE+, 4x 10/100/1000T(x) M12 Female X-coded 8-pole, auto negotiation speed duplex mode, auto MDI/MDI-X |
|--------------------------|---|

|                       |  |
|-----------------------|--|
| <b>LED Indicators</b> | <b>Per unit:</b> PWR1, PWR2, Status<br><b>Ports:</b> Link/Active<br><b>PoE:</b> Output Power |
|-----------------------|--|

#### Power Requirements

|                          |   |
|--------------------------|---|
| <b>Operation Voltage</b> | 9-36VDC; 19-75VDC; 43-160VDC, redundant dual inputs, >50VDC for PoE+ output recommended |
|--------------------------|---|

|                   |                         |
|-------------------|-------------------------|
| <b>Connection</b> | M12 Male S-coded 4-pole |
|-------------------|-------------------------|

|                          |   |
|--------------------------|---|
| <b>Power Consumption</b> | 0.39A@24VDC; 0.21A@48VDC;<br>0.12A@110VDC |
|--------------------------|---|

|                         |   |
|-------------------------|---|
| <b>PoE Power Budget</b> | Max. 30 W per PoE port. Max. total output power for PD: 165W@24V input (normal temp.); 60W@24V input (75°C) |
|-------------------------|---|

|                   |  |
|-------------------|--|
| <b>Protection</b> | Overload Current Protected, Reverse Polarity Protected |
|-------------------|--|

#### Mechanical Construction

|                  |      |
|------------------|------|
| <b>Enclosure</b> | SECC |
|------------------|------|

|                         |                     |
|-------------------------|---------------------|
| <b>Protection Class</b> | IP40/IP54(Optional) |
|-------------------------|---------------------|

|                   |                      |
|-------------------|----------------------|
| <b>Dimensions</b> | 181x99x94 mm (WxHxD) |
|-------------------|----------------------|

|               |         |
|---------------|---------|
| <b>Weight</b> | 1.55 kg |
|---------------|---------|

|                 |  |
|-----------------|--|
| <b>Mounting</b> | Wall Mounting Kits, Optional DIN-Rail Mounting |
|-----------------|--|

#### Environmental Limits

|                              |  |
|------------------------------|--|
| <b>Operating Temperature</b> | Extended: -40°C ~ 75°C (-40°F ~ 167°F) |
|------------------------------|--|

|                            |                              |
|----------------------------|------------------------------|
| <b>Storage Temperature</b> | -40°C ~ 85°C (-40°F ~ 185°F) |
|----------------------------|------------------------------|

|                                  |                            |
|----------------------------------|----------------------------|
| <b>Ambient Relative Humidity</b> | 5 to 95%, (Non-Condensing) |
|----------------------------------|----------------------------|

#### Regulatory Approvals

|                  |   |
|------------------|---|
| <b>EMI</b>       | FCC Part 15 Subpart B Class A<br>CE EN 55032 Class A  |
| <b>EMS</b>       | IEC61000-4-2 (ESD)<br>IEC61000-4-3 (RS)<br>IEC61000-4-4 (EFT)<br>IEC61000-4-5 (Surge)<br>IEC61000-4-6 (CS)<br>IEC61000-4-8 (Magnetic Field) |
| <b>Free Fall</b> | IEC60068-2-32   |

|                       |                                  |
|-----------------------|----------------------------------|
| <b>Shock</b>          | IEC61373                         |
| <b>Vibration</b>      | IEC61373                         |
| <b>Green</b>          | RoHS Compliant                   |
| <b>Certifications</b> | EN 50155<br>EN 45545-2<br>E-Mark |
| <b>MTBF</b>           | >100,000 hours                   |
| <b>Warranty</b>       | 5 Years                          |

Features with star(\*) implies those are under development.  
In a continuing effort of improvement and updated technology, product specifications are subject to change without notice.

## Dimensions (unit = mm)

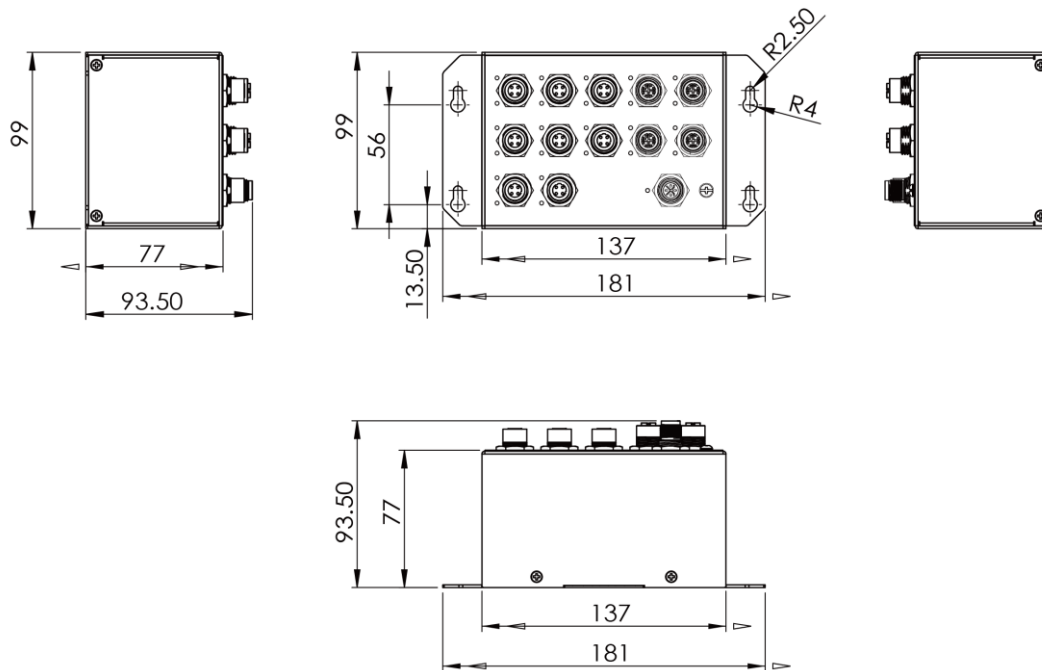

## Ordering Information

|                              |  |
|------------------------------|--|
| <b>ET-0804C-M12-24V2U-T</b>  | 12 Port M12 Industrial Unmanaged PoE+ Booster Gigabit Ethernet Switch<br>- 8x 10/100T(x) with 30W PSE + 4x 10/100/1000T(x) M12 connector<br>- Power Input: 24VDC<br>- Max. Power Budget: 165W<br>- Operating Temperature: -40°C ~ 75°C (-40°F ~ 167°F)<br>- Protection Class: IP40 |
| <b>ET-0804C-M12-24V2U-WT</b> | 12 Port M12 Industrial Unmanaged PoE+ Booster Gigabit Ethernet Switch<br>- 8x 10/100T(x) with 30W PSE + 4x 10/100/1000T(x) M12 connector<br>- Power Input: 24VDC<br>- Max. Power Budget: 165W<br>- Operating Temperature: -40°C ~ 75°C (-40°F ~ 167°F)<br>- Protection Class: IP54 |
| <b>ET-0804C-M12-48V2U-T</b>  | 12 Port M12 Industrial Unmanaged PoE+ Booster Gigabit Ethernet Switch<br>- 8x 10/100T(x) with 30W PSE + 4x 10/100/1000T(x) M12 connector<br>- Power Input: 48VDC<br>- Max. Power Budget: 165W<br>- Operating Temperature: -40°C ~ 75°C (-40°F ~ 167°F)<br>- Protection Class: IP40 |
| <b>ET-0804C-M12-48V2U-WT</b> | 12 Port M12 Industrial Unmanaged PoE+ Booster Gigabit Ethernet Switch<br>- 8x 10/100T(x) with 30W PSE + 4x 10/100/1000T(x) M12 connector   |

- Power Input: 48VDC
- Max. Power Budget: 165W
- Operating Temperature: -40°C ~ 75°C (-40°F ~ 167°F)
- Protection Class: IP54

---

**ET-0804C-M12-HV2U-T**

- 12 Port M12 Industrial Unmanaged PoE+ Booster Gigabit Ethernet Switch
- 8x 10/100T(x) with 30W PSE + 4x 10/100/1000T(x) M12 connector
  - Power Input: 72-110VDC
  - Max. Power Budget: 165W
  - Operating Temperature: -40°C ~ 75°C (-40°F ~ 167°F)
  - Protection Class: IP40

---

**ET-0804C-M12-HV2U-WT**

- 12 Port M12 Industrial Unmanaged PoE+ Booster Gigabit Ethernet Switch
- 8x 10/100T(x) with 30W PSE + 4x 10/100/1000T(x) M12 connector
  - Power Input: 72-110VDC
  - Max. Power Budget: 165W
  - Operating Temperature: -40°C ~ 75°C (-40°F ~ 167°F)
  - Protection Class: IP54