

ET-0804C-M12

12 Port M12 Industrial Unmanaged PoE+ Booster Gigabit Ethernet Switch



- Compliant with EN50155
- 8x 10/100T(x) M12 connector with IEEE 802.3at PoE+
- 4x 10/100/1000T(x) M12 connector with relay bypass
- Support Bypass function for non-stop communication even when no power exists
- Built for harsh environments and wide temperature range application
- IP40/IP54(Optional) housing
- Isolated redundant PoE power 190W



Specifications

Technology

Standards	IEEE 802.3 10BaseT IEEE 802.3u 100BaseTX IEEE 802.3ab 1000BaseT IEEE 802.3af Power over Ethernet IEEE 802.3at PoE+
------------------	--

Processing Type	Store and Forward
------------------------	-------------------

Switch Properties

Switch Fabric	9.6Gbps
----------------------	---------

Priority Queues	-
------------------------	---

MAC Table Size	8K
-----------------------	----

Packet Buffer	4Mbits
----------------------	--------

Interface

Network Connector	8x 10/100T(x) M12 Female D-coded 4-pole with PoE+, 4x 10/100/1000T(x) M12 Female X-coded 8-pole, auto negotiation speed duplex mode, auto MDI/MDI-X
--------------------------	---

LED Indicators	Per unit: PWR1, PWR2, Status Ports: Link/Active PoE: Output Power
-----------------------	--

Power Requirements

Operation Voltage	24VDC, 48VDC, HV: 72-110VDC, redundant dual inputs
--------------------------	--

Connection	M12 Male S-coded 4-pole
-------------------	-------------------------

Power Consumption	15W without PDs' consumption
--------------------------	------------------------------

PoE Power Budget	Max. 30 W per PoE port. Max. total output power for PD: 165W@24V input (normal temp.); 75W@24V input (75°C)
-------------------------	---

Protection	Overload Current Protected, Reverse Polarity Protected
-------------------	--

Mechanical Construction

Enclosure	SECC
------------------	------

Protection Class	IP40/IP54(Optional)
-------------------------	---------------------

Dimensions	181x99x94 mm (WxHxD)
-------------------	----------------------

Weight	1.20 kg
---------------	---------

Mounting	Wall Mounting Kits, Optional DIN-Rail Mounting
-----------------	--

Environmental Limits

Operating Temperature	Extended: -40°C ~ 75°C (-40°F ~ 167°F)
------------------------------	--

Storage Temperature	-40°C ~ 85°C (-40°F ~ 185°F)
----------------------------	------------------------------

Ambient Relative Humidity	5 to 95%, (Non-Condensing)
----------------------------------	----------------------------

Regulatory Approvals

EMI	FCC Part 15 Subpart B Class A CE EN 55032 Class A
EMS	IEC61000-4-2 (ESD)
	IEC61000-4-3 (RS)
	IEC61000-4-4 (EFT)
	IEC61000-4-5 (Surge)
	IEC61000-4-6 (CS)
IEC61000-4-8 (Magnetic Field)	
Free Fall	IEC60068-2-32

Shock	IEC61373
Vibration	IEC61373
Green	RoHS Compliant
Certifications	EN 50155
	EN 45545-2
MTBF	>100,000 hours
Warranty	5 Years

Features with star(*) implies those are under development.
In a continuing effort of improvement and updated technology, product specifications are subject to change without notice.

Dimensions (unit = mm)

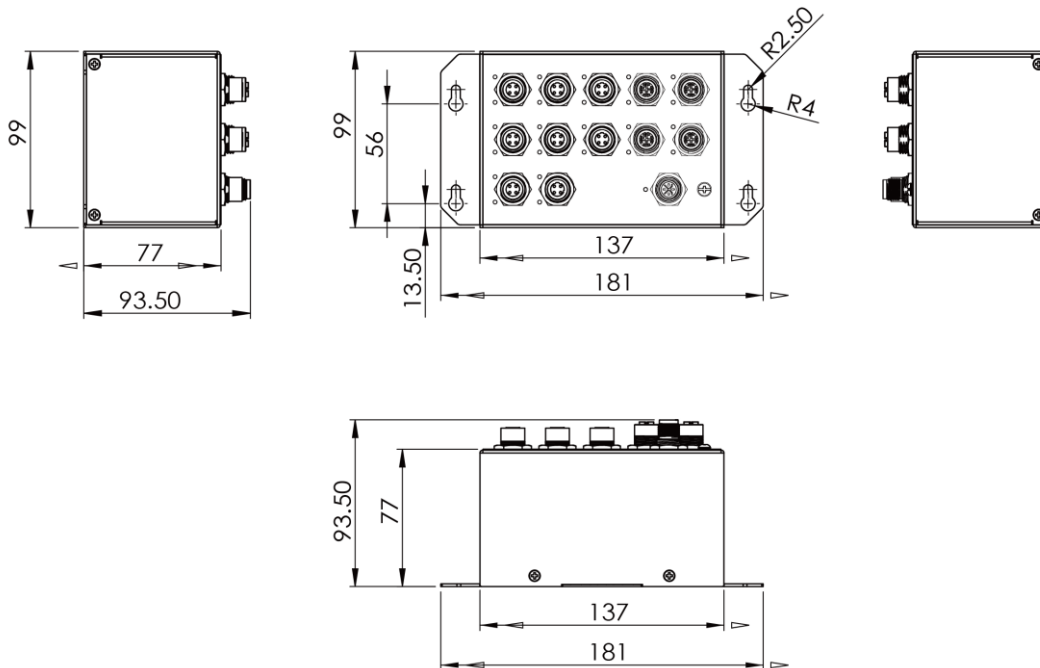

Ordering Information

ET-0804C-M12-24V2U-T	<p>12 Port M12 Industrial Unmanaged PoE+ Booster Gigabit Ethernet Switch</p> <ul style="list-style-type: none"> - 8x 10/100T(x) with 30W PSE + 4x 10/100/1000T(x) M12 connector - Power Input: 24VDC - Max. Power Budget: 190W - Operating Temperature: -40°C ~ 75°C (-40°F ~ 167°F) - Protection Class: IP40 - UL Compliant
ET-0804C-M12-24V2U-WT	<p>12 Port M12 Industrial Unmanaged PoE+ Booster Gigabit Ethernet Switch</p> <ul style="list-style-type: none"> - 8x 10/100T(x) with 30W PSE + 4x 10/100/1000T(x) M12 connector - Power Input: 24VDC - Max. Power Budget: 190W - Operating Temperature: -40°C ~ 75°C (-40°F ~ 167°F) - Protection Class: IP54 - UL Compliant
ET-0804C-M12-48V2U-T	<p>12 Port M12 Industrial Unmanaged PoE+ Booster Gigabit Ethernet Switch</p> <ul style="list-style-type: none"> - 8x 10/100T(x) with 30W PSE + 4x 10/100/1000T(x) M12 connector - Power Input: 48VDC - Max. Power Budget: 190W - Operating Temperature: -40°C ~ 75°C (-40°F ~ 167°F) - Protection Class: IP40

ET-0804C-M12-48V2U-WT	<ul style="list-style-type: none"> - UL Compliant <hr/> <p>12 Port M12 Industrial Unmanaged PoE+ Booster Gigabit Ethernet Switch</p> <ul style="list-style-type: none"> - 8x 10/100T(x) with 30W PSE + 4x 10/100/1000T(x) M12 connector - Power Input: 48VDC - Max. Power Budget: 190W - Operating Temperature: -40°C ~ 75°C (-40°F ~ 167°F) - Protection Class: IP54 - UL Compliant
ET-0804C-M12-HV2U-T	<hr/> <p>12 Port M12 Industrial Unmanaged PoE+ Booster Gigabit Ethernet Switch</p> <ul style="list-style-type: none"> - 8x 10/100T(x) with 30W PSE + 4x 10/100/1000T(x) M12 connector - Power Input: 72-110VDC - Max. Power Budget: 156W - Operating Temperature: -40°C ~ 75°C (-40°F ~ 167°F) - Protection Class: IP40 - UL Compliant
ET-0804C-M12-HV2U-WT	<hr/> <p>12 Port M12 Industrial Unmanaged PoE+ Booster Gigabit Ethernet Switch</p> <ul style="list-style-type: none"> - 8x 10/100T(x) with 30W PSE + 4x 10/100/1000T(x) M12 connector - Power Input: 72-110VDC - Max. Power Budget: 156W - Operating Temperature: -40°C ~ 75°C (-40°F ~ 167°F) - Protection Class: IP54 - UL Compliant